

## Tapered handles

with protection, Duroplast

### MATERIAL

Phenolic based (PF) Duroplast body, polyamide based (PA) technopolymer flange, black colour, glossy finish.

### STANDARD EXECUTION

Zinc-plated steel threaded stud, chamfered flat end according to UNI 947 : ISO 4753 (see Technical Data).

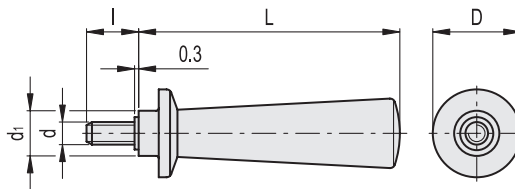

### I.167 p

Code	Description	D	L	d <sub>1</sub>	d <sub>6g</sub>	l	Δ
20306	I.167/103 p-M8x16	27	104	18	M8	16	90
20311	I.167/103 p-M8x25	27	104	18	M8	25	94